



### 150 Gallon Patch Kettle (Towable)

The perfect kettle for small repair jobs. Short heat up time and small physical size.

Product #:	101104
Weight:	1350 lbs
Capacity:	160 US Gallons
Dimensions:	120" x 64" x 48"
Optional:	Emission Control System
Usable Capacity	100 US Gallons

# Asphalt Kettles

From their heavy duty schedule 40 blast tubes to their thick inner and outer skins, ASE kettles have a well earned reputation as high production asphalt kettles that last.

## Standard Features

- 9 H.P. Honda Engine
- 2" Viking Pump 80 GPM (Submerged)
- Quick-acting Flow Control Valve System
- 30ft. Propane Hose
- Draincock: 2 1/2" Steel Pipe (Not cast)
- Heavy Duty Channel Frame
- Heavy Duty Fenders
- Electric Brakes on all Axles
- Pintle Hitch
- 12 Ply Truck Tires
- Hinged, Lockable Engine Cover
- Jack Leg
- 7 Pole Round Lights Connector

## Options

- Emission Control System
- Clevis Pin Hitch
- Ball Hitch
- 6 Pole Round Lights Connector
- Tool Box on Canadian Kettles

# Technical Specifications

## Kettle Comparison Chart

	400 gal.	600 gal.	850 gal.
Product Number	101106 (Canada)	101107 (Canada)	101108 (Canada)
Capacity (US Gal)	400	620	850
Useable (US Gal)	310	490	670
Engine	9 HP Honda	9 HP Honda	9 HP Honda
Pump	2" Viking	2" Viking	2" Viking
Burners	2	2	2
Lids	1	2	2
Axles	1	2	2
Axle Rating	6000	6000	6000
Tire Size	62-8-14.5LT	62-8-14.5LT	62-8-14.5LT
Electric Brakes	Standard	Standard	Standard
Breakaway Brakes	Optional	Standard	Standard
Loading Height (in)	42	44	44
Length (in)	178	210	247
Width (in)	83.5	88	88
Height (in)	50	52	52
Weight (lbs)	2650	4900	5400
Hitch (Canada)	Pintle	Pintle	Pintle



**400 Gallon Kettle**



**600 Gallon Kettle**



**850 Gallon Kettle**

# Patch Kettles & Options

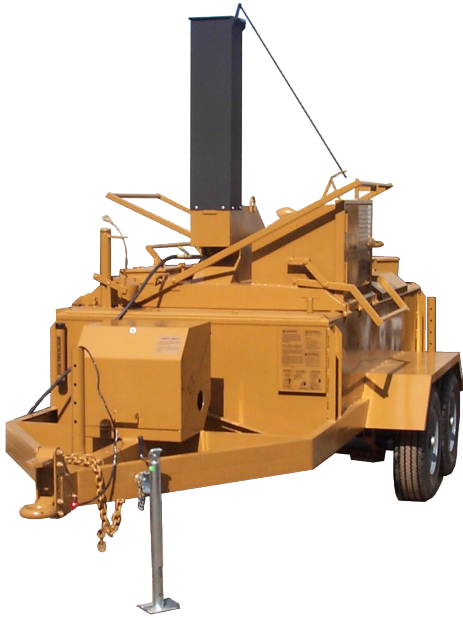

## Remove Emissions in minutes

### Kettle Standard Features

- LP Burner
- Shut Off Valve
- 2.5" Steel Draincock (Not Cast)
- 30ft. Propane Hose
- LP Regulator
- Thermometer

### Emission Control System

Removeable Stainless Steel Burner Stack. Stainless Steel fire baffle screens. Skim door on 400 and larger kettles

101245	100 Gal emission burner system
101247	150 Gal emission burner system
101249	400 Gal emission burner system
101250	600-850-1250 Gal emission system
101262	Tool box for Kettle



### 45 Gallon Patch Kettle (Standard)

Mostly used for small repairs such as patch work. Its small size allows easy access to tight spots.

Product #:	101000
Weight:	350 lbs
Capacity:	45 US Gallons
Dimensions:	49" x 22" x 37"
Optional:	N/A



### 100 Gallon Patch Kettle (On-Deck)

Light enough to be hoisted to the roof, small enough to take in an elevator.

Product #:	101002
Weight:	596 lbs
Capacity:	100 US Gallons
Dimensions:	55" x 33" x 46"
Optional:	Emission Control System



### Kettle Pipe Elbow

- 101730 - Pipe Elbow - 1 1/2" x 90°
- 101731 - Threaded Elbow - 2" x 90°
- 101735 - Pipe Elbow - 2" x 90°
- 101736 - Threaded Elbow - 1 1/2" x 90°



### Regulator

- 201123 - Regulator Complete Liquid
- 201125 - Vapor Regulator



### Propane Hose

- 201130 - 3/8 HOSE x 15FT
- 201132 - 3/8 HOSE x 3FT
- 201133 - 3/8 HOSE x 30FT



### Coupling

- 201700 - Coupling - 1 1/2" Steel
- 201701 - Coupling - 2" Steel
- 201702 - Coupling Reducer - 2" to 1 1/2"
- 201703 - Coupling Reducer - 1 1/2" to 1 1/4"



### Draincock

- 201721 - Draincock - 2 1/2"



### Global Valve 1/4"

- 201121 - Ball Valve 1/4" Brass



### Jack Leg

- 201034 - Industrial Jack - 5000LB



### Kettle Skimmer

- 101420 - Kettle Skimmer

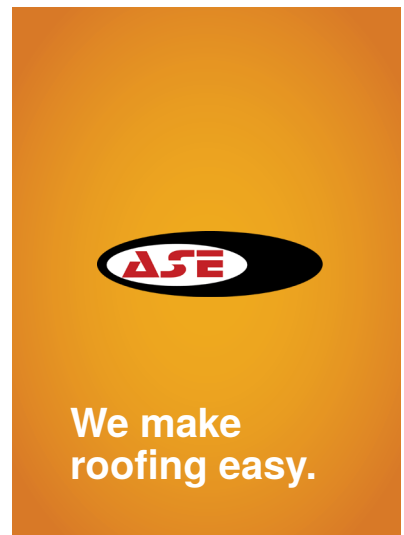

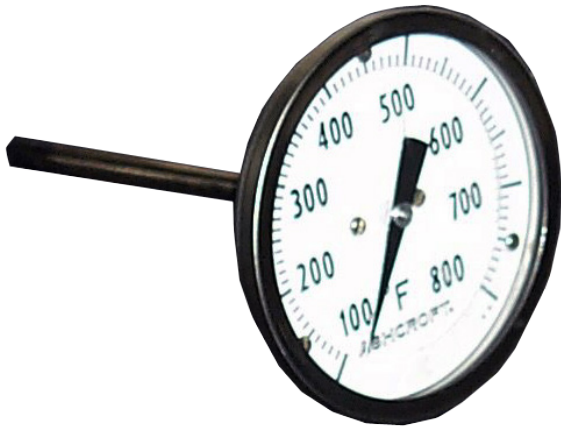

### Thermometer

- 201193 - Kettle Thermometer 3" Dial x 4" Stem
- 201192 - Kettle Thermometer 3" Dial x 12" Stem
- 201196 - Kettle Thermometer 3" Dial x 15" Stem
- 201197 - Kettle Thermometer 3" Dial x 24" Stem



### Plumbing Elbow Joint

- 201710 - Street Elbow 1 1/2" x 90°
- 201711 - Street Elbow 2" x 90°
- 201712 - Street Elbow 2 1/2" x 90°
- 201714 - Street Elbow 1 1/2" x 90°

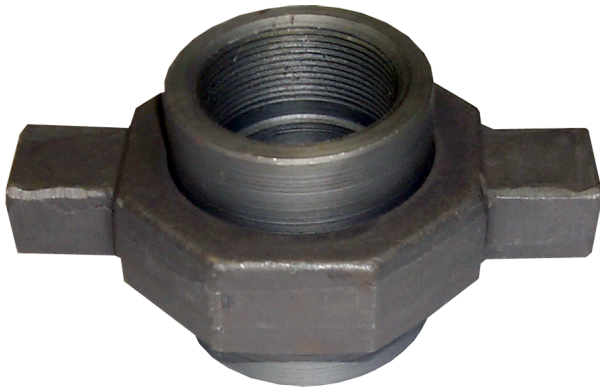

### Plumbing Union Hammer-On

- 201704 - 1 1/2" Hammer-On
- 201707 - 2" Hammer-On

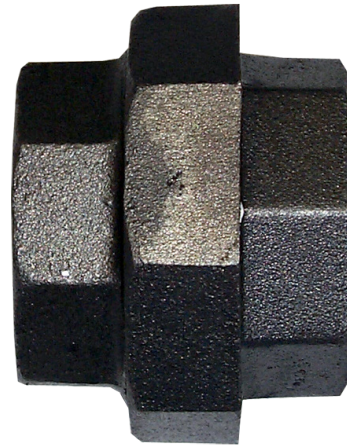

### Plumbing Union

- 201705 - 1 1/2" Union
- 201706 - 2" Union

**Built on the highest safety & quality standards**

When it comes to roofing equipment, don't settle for anything less than the best. ASE has you covered.



### Flex Hose / Insulated Flex Hose

- 101739 - Flex Hose 1 ½" x 3' (No Sleeve)
- 101740 - Flex Hose 1 ½" x 5' (No Sleeve)
- 101741 - Flex Hose 2" x 3' (No Sleeve)
- 101742 - Flex Hose 2" x 5' (No Sleeve)
- 101750 - Flex Hose 1 ½" x 3' (Insulated Sleeve)
- 101751 - Flex Hose 1 ½" x 5' (Insulated Sleeve)
- 101755 - Flex Hose 2" x 3' (Insulated Sleeve)
- 101756 - Flex Hose 2" x 5' (Insulated Sleeve)
- 101701 - Kettle Pipe 1 ½" x 5' (Thin Wall)
- 101702 - Kettle Pipe 1 ½" x 10' (Thin Wall)
- 101703 - Kettle Pipe 1 ½" x 15' (Thin Wall)
- 101704 - Kettle Pipe 1 ½" x 20' (Thin Wall)
- 101720 - Kettle Pipe 2 x 5' (Thin Wall)
- 101721 - Kettle Pipe 2 x 10' (Thin Wall)
- 101722 - Kettle Pipe 2 x 15' (Thin Wall)
- 101723 - Kettle Pipe 2 x 20' (Thin Wall)

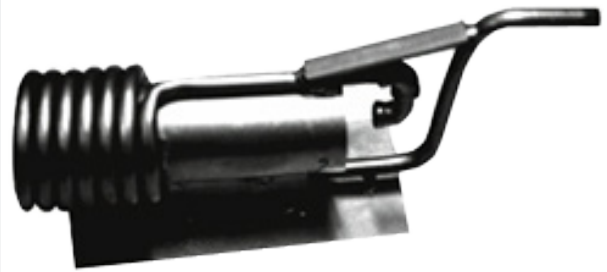

### Kettle Burner

#### BURNER ONLY

- 201134 - Liquid Burner (Patch Pot 45 Gallon)
- 201138 - Liquid Burner (100 Gallon)
- 201139 - Liquid Burner (150 Gallon)
- 201140 - Liquid Burner (300 Gallon)
- 201141 - Liquid Burner (400 Gallon)
- 201142 - Liquid Burner (600/850 Gallon)
- 201143 - Liquid Burner (1250 Gallon)

#### BURNER SET

- 201145 - Liquid Burner (Patch Pot 45 Gallon)
- 201146 - Liquid Burner (100 Gallon)
- 201147 - Liquid Burner (150 Gallon)
- 201148 - Liquid Burner (300 Gallon)
- 201149 - Liquid Burner (400 Gallon)
- 201150 - Liquid Burner (600/850 Gallon)
- 201152 - Liquid Burner (1250 Gallon)
- 201155 - Liquid Burner (240/400 Gallon HTK)